

SPECIFICATION FOR APPROVAL

※This is a RoHS and REACH compliant product whose related documents are available on request.

※Graphic is only for dimensionally application.

1. PART NUMBERING : PRODUCT IDENTIFICATION

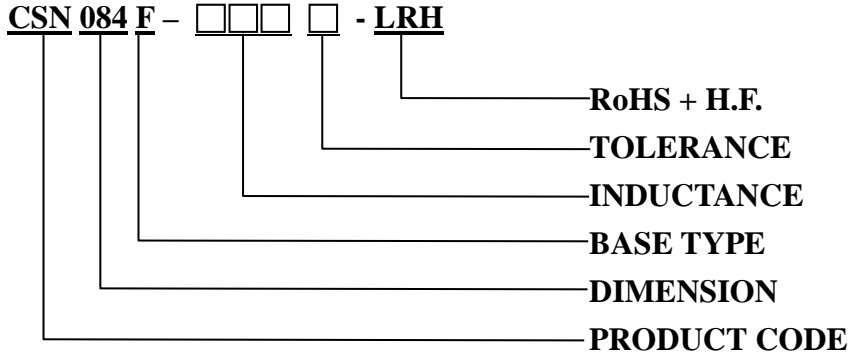

2. MECHANICAL DIMENSION

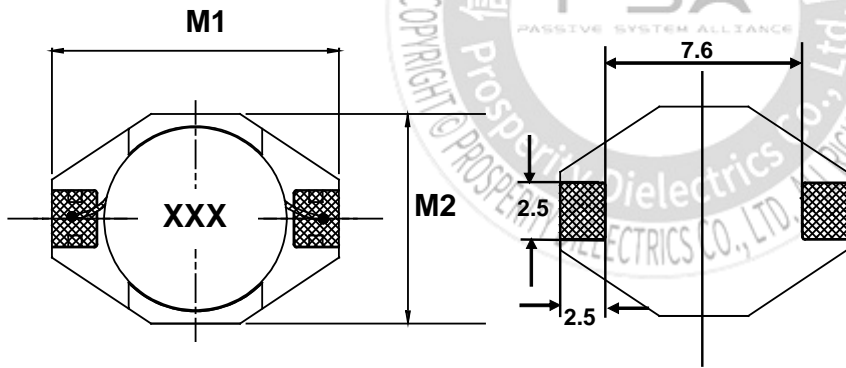

UNIT: mm

	DIM.	TOL.
M1	12.95	MAX.
M2	9.40	MAX.
M3	5.21	MAX.

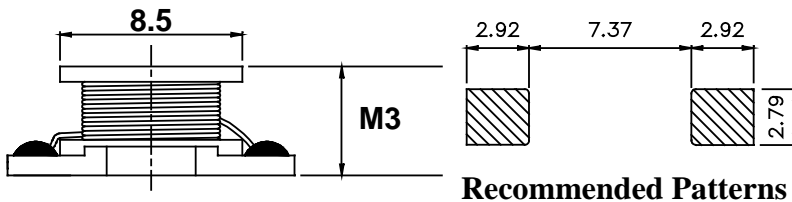

SPECIFICATION FOR APPROVAL

3. ELECTRICAL SPECIFICATION

Part number	Marking	Inductance (uH)	Test Frequency (KHz)	DC Resistance (Ω) MAX.	I sat (A)	Rated Current (A)
CSN084F-1R0M-LRH	1R0	1.0	100	0.009	9.00	6.80
CSN084F-1R5M-LRH	1R5	1.5	100	0.010	8.00	6.40
CSN084F-2R2M-LRH	2R2	2.2	100	0.012	7.00	6.10
CSN084F-3R3M-LRH	3R3	3.3	100	0.015	6.40	5.40
CSN084F-4R7M-LRH	4R7	4.7	100	0.018	5.40	4.80
CSN084F-6R8M-LRH	6R8	6.8	100	0.027	4.60	4.40
CSN084F-100M-LRH	100	10.0	100	0.038	3.80	3.90
CSN084F-150M-LRH	150	15.0	100	0.046	3.00	3.10
CSN084F-220M-LRH	220	22.0	100	0.085	2.60	2.70
CSN084F-330M-LRH	330	33.0	100	0.100	2.00	2.10
CSN084F-470M-LRH	470	47.0	100	0.140	1.60	1.80
CSN084F-680M-LRH	680	68.0	100	0.200	1.40	1.50
CSN084F-101M-LRH	101	100.0	100	0.280	1.20	1.30
CSN084F-151M-LRH	151	150.0	100	0.400	1.00	1.00
CSN084F-221M-LRH	221	220.0	100	0.610	0.80	0.80
CSN084F-331M-LRH	331	330.0	100	1.020	0.60	0.60
CSN084F-471M-LRH	471	470.0	100	1.270	0.50	0.50
CSN084F-681M-LRH	681	680.0	100	2.020	0.40	0.40
CSN084F-102M-LRH	102	1000.0	100	3.000	0.30	0.30
CSN084F-152M-LRH	152	1500.0	100	5.000	0.25	0.25

NOTE:

1. Tolerance: M: ±20%
2. Operating temperature range: -25°C to +125°C.
3. Storage temperature range: -25°C to +85°C.
4. Inductance measured using the HP4284A LCR meter, CHROMA1320 & 3302.
5. DCR measured using the 16502 milli-ohm meter.
6. Inductance drops no more than 10 % of initial value at Isat , temperature rises $\Delta t < 40^{\circ}\text{C}$ at rated current.
7. MSL: Level 1